



Never Again Change Out an Under-Counter Refrigerator

Medical / Lab-Grade Under-Counter Refrigerator



Why Choose VersaFridge?

- Lifetime Warranty on Cabinet
- 5-Year Warranty on "Slide-In, Slide-Out" Compressor/Electronics Module
- Versatile Storage: Mix & Match Interchangeable Drawers & Shelves
- At Least 4 Times More Energy-Efficient Than Rival Models
- Never, Ever Requires Service Call or Costly Technician Assistance
- 100% Front Serviceable—No Refrigerator Access Required

VERSAFRIDGE™ *The Forever System—Infinitely Better*

A Quantum Leap Forward in Medical/Lab-Grade Refrigeration

VersaFridge medical/lab-grade refrigerators for healthcare facilities are a technological advancement that changes everything. Before now, failure of a refrigeration unit meant costly service calls and parts, or the further disruption of hauling the old, dead refrigerator away, and installing a new one, often on top of the service-call costs.

Never again! Those costly, wasteful, disruptive days are gone forever, with VersaFridge—The Forever System. VersaFridge features a revolutionary “slide-in” replaceable modular power pack that renders old-style fixed-compressor units obsolete. Never again replace the storage compartment or transfer stored items when a compressor fails.

Count on VersaFridge for Innovation in Design & Performance

1 Modular Power-Pack Key to “Forever” System

A front-loading, slide-in/slide-out modular power-pack contains compressor, evaporator, heat exchanger, fan, and all operating electronics, making change-out so easy, a child could do it. Simple removal of four screws is all it takes. Also, VersaFridge units can operate at all voltages from 110 to 240, vAC



◀ You'll never have to remove or discard a medical-grade refrigeration unit again, with VersaFridge—The Forever System. Slide-out one module, slide-in another. Done!



VersaFridge modules feature ▶ slide-in electrical docking so that there are no wires to loosen or reattach when changing out a modular power pack.

▲ Integrated Automatic Voltage Adjustment 110-240 vAC

2 Saves Energy & Environment

VersaFridge features an energy-efficient design that uses no more than 25 percent of the energy used by other medical/lab-grade brands. VersaFridge uses no more than 1.4 amps of power at compressor start-up, and only 1.1 amps in the cooling mode, resulting in total KWH consumption of less than one KWH on average, per day. Per month, that's under \$2.75* in energy use. VersaFridge has the independent test data to prove the accuracy of its efficiency profile.

Consider the Go-Green advantages:

1. For your healthcare facility, a major reduction in energy usage and energy cost, multiplied by the number of under-counter units you operate enterprise-wide;
2. No refrigerator compartments hauled away or added to landfill waste;
3. VersaFridge slide-in/slide-out modules are 100% recyclable—remove it, return it, VersaFridge refurbishes it!

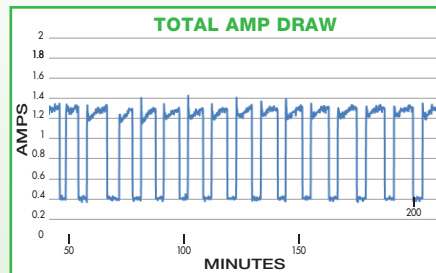

Your Go-Green choice saves energy, saves you operating expense, and saves the environment—a win-win-win!

* Energy rates, and therefore usage costs, may vary based on geographic location

3 More Storage Capacity than Competitors

More space inside the refrigerator cooling compartment, because of compact compressor design—now 40% more storage space when compared to the designs of competitive models.



VersaFridge compressor module measures 22X17X5-inches (559mm x 432mm x 127mm), while competitive medical-grade refrigeration unit compressor compartments measure at least 24x24x10 inches (609mm x 609mm x 254mm).

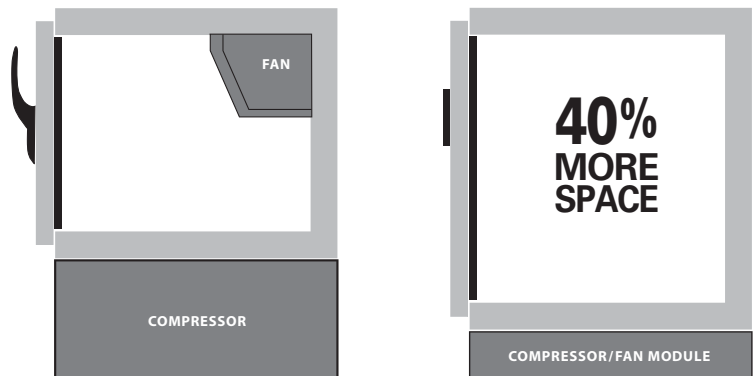

Competitive Models

VersaFridge

Also, VersaFridge cooling evaporator fan is housed in the compressor module, while fans in competitive models take up additional box storage space.

4 Front-Access Module for Easy, Fast Change-Out

The 100% in-front accessibility of the modular power-pack means that you'll never again need to remove or replace the refrigerator.



If a power-pack fails, slide out the old, slide in the new.

If a modular power-pack fails, no need to move or empty the refrigeration unit, no need to call a service person, no need to haul in a toolbox for removal of the compressor module. A simple screwdriver is all it takes; slide out the old, slide in the new, and the unit is back in service. It's that simple!

5 Glass Door Advantage for Users

VersaFridge is available in the new glass-door model for applications where seeing the contents in the refrigerator without having to open the door is a user advantage. Doors feature double-pane, shatter-resistant tempered glass for optimum safety, energy efficiency and durability.



VersaFridge Glass-door models are ideal for situations where you want to see inside the unit without opening it. Wonderful for blood bank storage or high use medication storage areas

6 Innovative VersaFridge & VersaTrak A Powerful Combination

VersaFridge truly is innovative and versatile, featuring unique user options that provide the ultimate in refrigerator flexibility and temperature monitoring capability. VersaFridge and VersaTrak* in combination provide industry-leading features:

- Built-in port & wiring for VersaTrak® monitoring devices**
- Capability to monitor two internal temperatures and door status simultaneously, with one transmitter
- Door-status contact switch built in at the factory
- Variety of product simulators for more exact product monitoring
- Electrical integration to power VersaTrak transmitter through refrigerator power supply, extending life of transmitter back-up battery system to 15 years



WiFi Temperature Sensor (Part #10131)



Product Simulators

* For more information on VersaTrak Systems, visit www.veracitygroupinc.com
 ** VersaFridge also is designed to accommodate monitoring devices provided by other manufacturers

7 Control Access with VersaFridge Keypad Lock

Electronic keypad locking systems from VersaFridge are available in deadbolt and slam-latch models. Keypad is designed to be used with either right-hand or left-hand hinged doors. No tools or penetrations of the refrigerator shell or door are needed to install the locking system.



Peel backing paper from powerful adhesive on hasp and keypad lock assembly and install. It's that easy!

8 Lock Boxes for Added Security

Interior lock box provides security for narcotic storage, or high dollar medication storage without having to have the entire refrigerator locked.



9 Specialized Handles & Adjustable Shelves, Drawers

Specialized Handles—VersaFridge offers specialized handle brackets for use with automated drug dispensing systems, including latch configurations for Pyxis®, Med-Select® and Omnicell® brands. Handle brackets can be installed with security-head screws. (Omnicell® not shown)

Shelves & Drawers—VersaFridge Mix & Match™ system allows you to configure the inside storage area as you prefer, and you can change at will. Want all drawers for now, and maybe change out a drawer for a shelf or two later? Can do! Want drawers of differing sizes in the same unit? Again, can do!

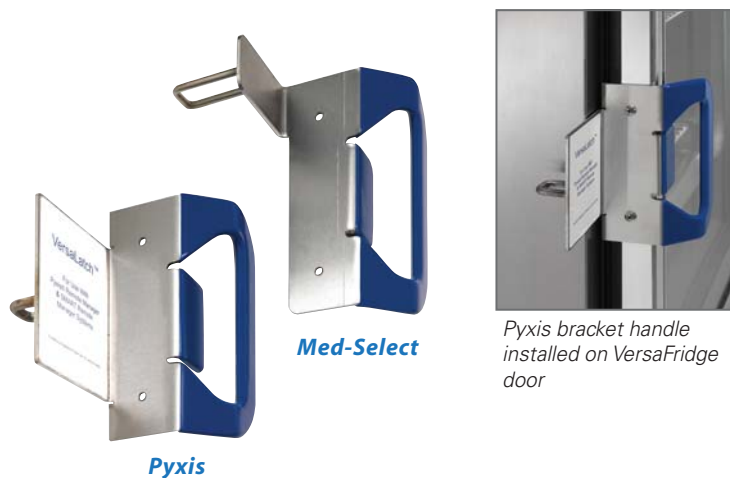

VersaFridge—Efficiency and Advantage for Healthcare Facilities

VersaFridge medical/lab-grade refrigeration units feature the first-and-only removable modular compressor-fan assembly (patent pending). This revolutionary leap forward in refrigeration technology changes everything. Never again will your healthcare facility experience:

- The cost of a service call for a problem refrigerator
- The need for maintenance personnel to cart off a failed refrigerator
- The disruption and cost of re-installing a new unit for a failed one

The Forever SystemSM from VersaFridge™ provides a truly positive impact on your facility's labor costs, energy usage costs and our environment.

VERSAFRIDGE™ The Forever System—Infinitely Better

Order with VersaTrak Wireless Temperature Monitor Built In



- **High performance compressor with modular forced air cooling refrigeration unit (only requires a screwdriver to service the unit)**
Refrigeration Module Maintains +/- 1° F (+/- .5° C)
CFC-Free Insulation



- **100% Front Breathing/Discharging & Front Serviceable**
- **State-of-the-Art Micro-processor Controller**
110/240 Volt—Built-in Auto Adjustment to Voltage
Easy-Read Digital Temperature Display
Adjustable Set Points



- *Supports Food, Medication, Blood and Lab Storage*
- Both Visual & Audible Alarms
- F and C Field Selectable
- Auto Defrost
- Dry Contact Alarm Relay



- **1-Inch Fully Welded Pan for Lab Use**
- **100% Usable Space (nearly 40% more than competitive models)**
- **100% Stainless Steel Construction for Ease of Maintenance & Cleaning**
- **Fully Welded & Polished Seams for More Sanitary Performance**



- **Field-Reversible Door**
Spring-Loaded Hinges to Assure Solid Door Closings
Magnetic Door Seal (no door latch to fail)
Standard Key Lock for Security & Positioned for Convenience
(Optional electronic lock with individual-user access codes)



- **Modular Shelving System (mix and match shelves and drawer in the same unit)**
- **Field Upgradeable, Enabling User to Change Shelf-Drawer Configurations at will**
Three Epoxy-Coated Shelves Standard
Optional—Full-Extension Stainless Steel Drawers



- **Front Temperature Probe Port for Ease of Installation**
- **Other Options:**



- Integrated VersaTrak Wireless System*
With Door Contact Sensor
With Two Temperature Sensors
Line Power Provided by Refrigerator Power
15-Year Battery Life
- Pyxis Door Bracket
- Omnicell Door Bracket
- Med-Select Door Bracket

* For more information on VersaTrak Systems, visit www.veracitygroupinc.com

VersaFridge—Best Fit for Hospitals & Health Care Facilities

Dimensions of VersaFridge Standard and ADA Models

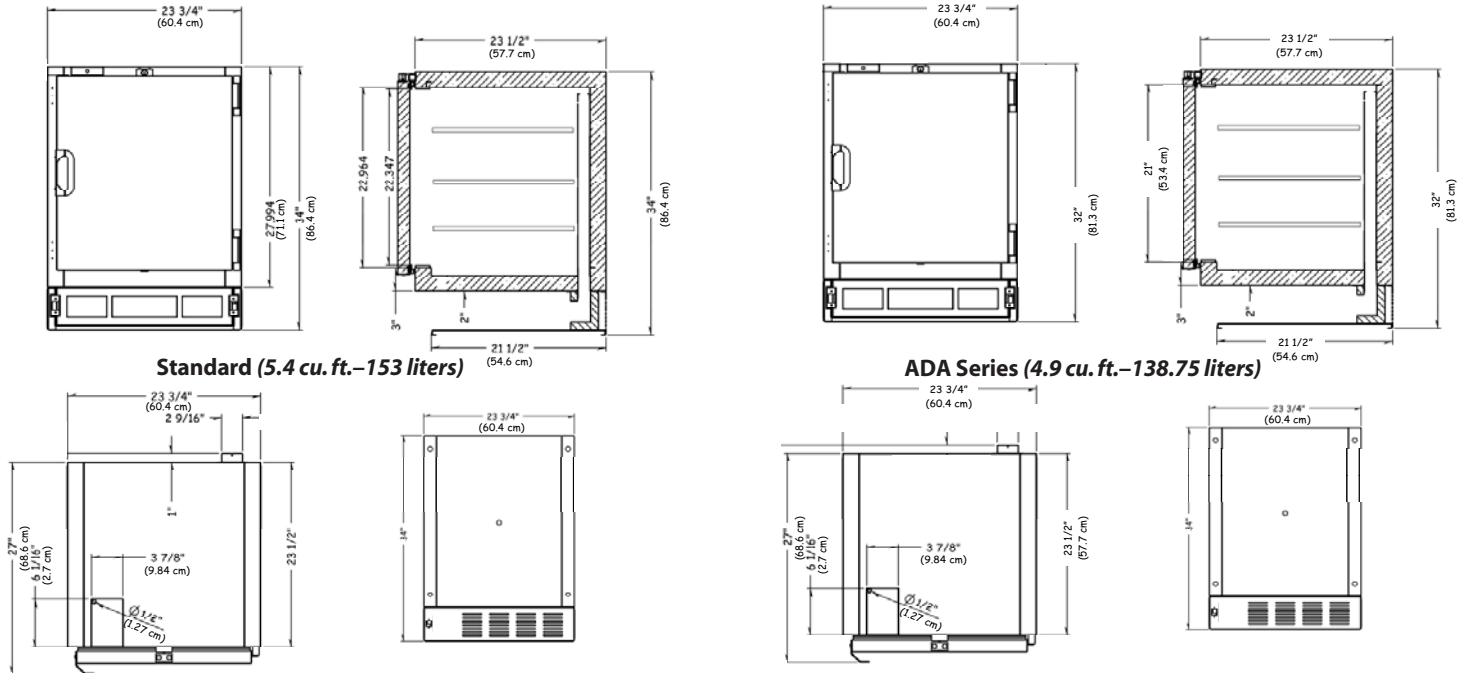

STACKABLE!

VersaFridge Designed for Stackable Applications

VersaFridge units are designed to be stacked. A stacking kit is available



Coming Soon!

The Micro & Mini Refrigerators From VersaFridge

Look for the new Micro-Fridge and Mini-Fridge, for applications where a little less space is just what is needed. The new smaller sized units are designed for counter-top applications and other situations where space is at a premium. The new refrigerator models currently are in testing and soon will be available.



INDUSTRY LEADING WARRANTY

- Five years on entire refrigeration system
- Lifetime on cabinet

Veracity Group Middle East
Grand Hamed Street, HBK Building
2nd Floor, PO Box: 20180
Doha
Qatar
Tel: +974 436 4818
Fax: +974 436 4727
www.veracitygroup-me.com
info@veracitygroup-me.com

VERACITY GROUP INC.
7575 Kemper Road
Cincinnati, OH 45249
888-369-3601

Veracity Group (UK & Europe)
Fallait
East Allington
Totnes
TQ97QE
Tel: +0044 1548 521357
www.veracitygroup.co.uk
info@veracitygroup.co.uk